

# Instruction for C400 Rope suspended

Rope suspended \*Caution! Before operation, please make sure the power is cut off.

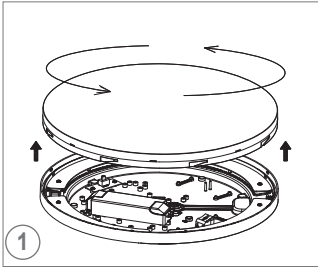

Twist the diffuser anticlockwise.  
Vertically remove the diffuser and PCBA.

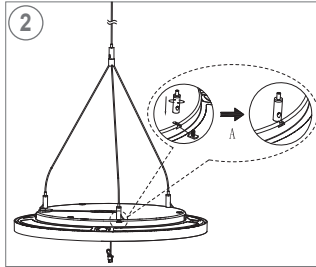

To secure rope onto the fixture, insert the T-shaped rivets to the slot on the reverse of the base, then tighten the rope clammers

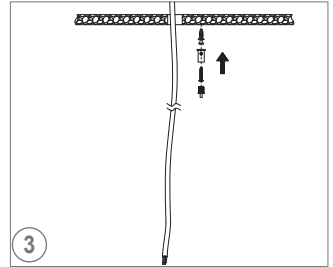

Knock the rawl plugs into the pre-drilled holes on ceiling. Fasten the rope clammer onto the ceiling with screw as shown.

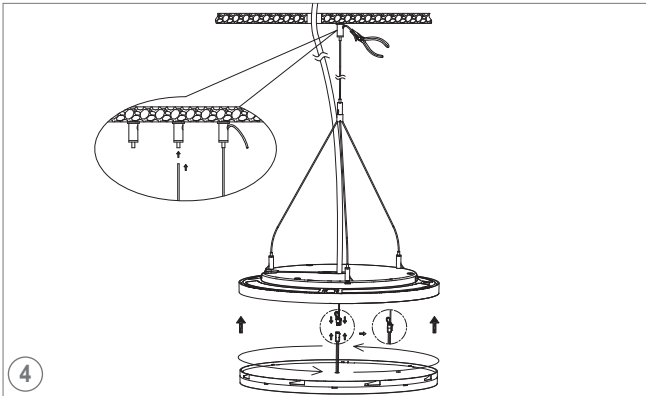

- a. Cut off the power. Thread the input cable through the rubber plug to the fixture.  
Connect the L, N wire referring to the wiring diagram.
- b. Connect the DC cable.
- c. Mount the diffuser onto the base by twisting clockwise.

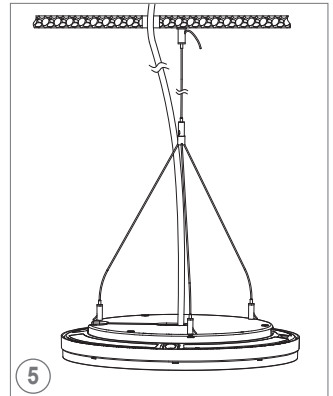

Installation finished.